

SS-TS300

SERVICE MANUAL

REVISED

US Model
Canadian Model
AEP Model
UK Model
E Model
Chinese Model
AUS Model



This set is the speaker system in DAV-S300.

SPECIFICATIONS

Speaker system : Bass reflex
Speaker unit : 2 $\frac{7}{8}$ inches (70 mm) dia. cone type
Rated impedance : 3 ohms
Dimensions (approx.) : 3 $\frac{7}{8}$ x 4 $\frac{1}{8}$ x 4 $\frac{1}{4}$ inches (97 x 102 x 105 mm) (w / h / d)
Mass (approx.) : 1 lb 4 oz (0.57 kg)

Design and specification are subject to change without notice.

SPEAKER SYSTEM

SONY®

EXPLODED VIEW AND PARTS LIST

NOTE:
• The mechanical parts with no reference number in the exploded views are not supplied.

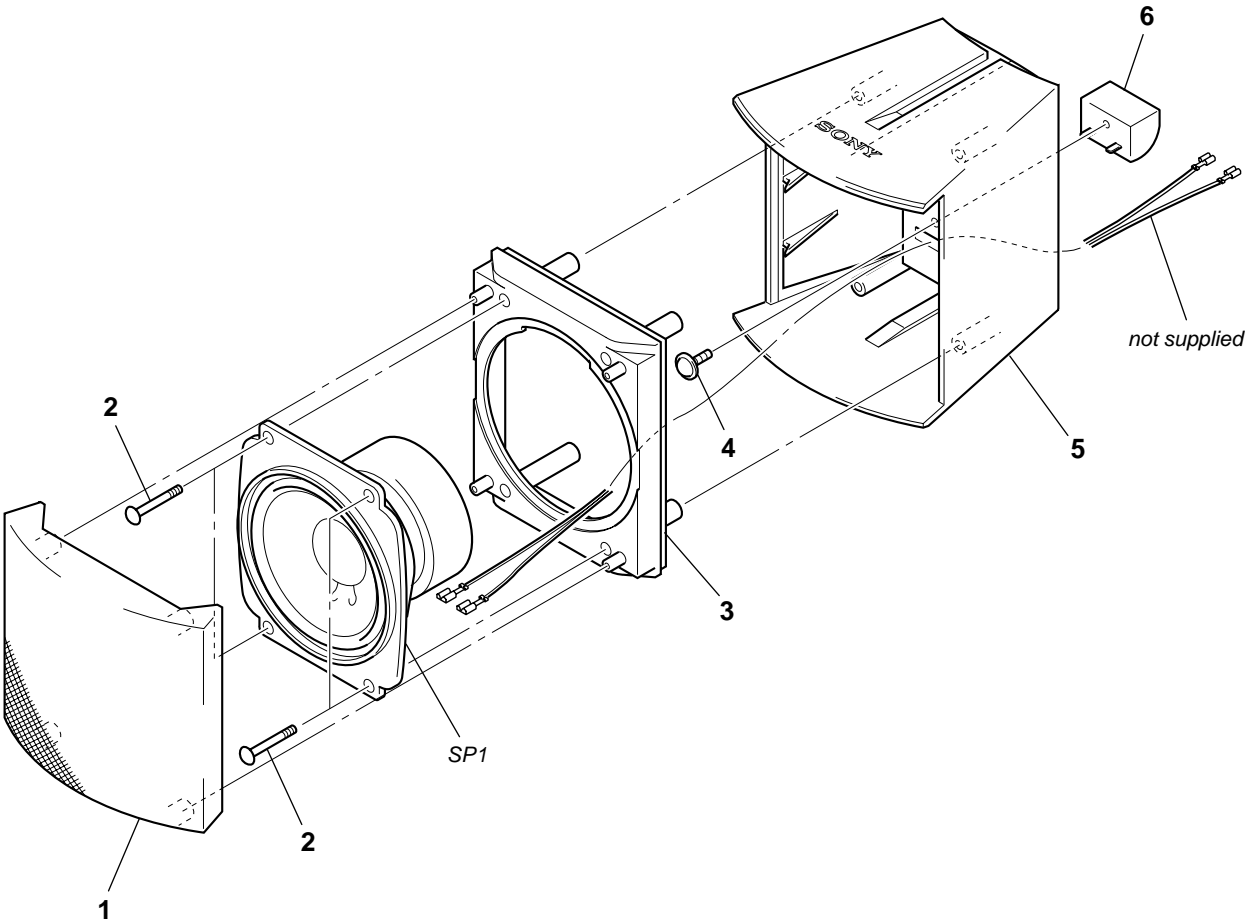

Ref. No.	Part No.	Description	Remark
1	X-4952-567-1	FRAME ASSY, GRILLE	
2	4-228-909-01	SPECIAL HEAD SCREW	
3	3-043-782-01	PANEL (SPK), FRONT	
4	7-685-904-59	+PWH 4X16	
5	3-043-779-01	CABINET (SPEAKER) (REAR)	
6	3-043-781-01	TERMINAL	
SP1	1-529-616-11	SPEAKER (80 mm)	